

OREGON PUBLIC LAND CORNER REPORT / RESTORATION REPORT
Tillamook County Surveyor's Office

SECTION: 13 & 14	TOWNSHIP: 1 South	RANGE: 10 West
COUNTY: Tillamook		DATE: 2/2022
CORNER DESIGNATION: Quarter corner common to Sections 13 and 14 Township 1 South, Range 10 West, Willamette Meridian		(Please check one)
		<input checked="" type="checkbox"/> Condition Report Only
		<input type="checkbox"/> Restoration
		<input type="checkbox"/> Rewitness
		<input type="checkbox"/> Unrecorded
		<input type="checkbox"/> Reset at surface
		<input type="checkbox"/> Referenced Out

Previous Rewitnesses, Restorations, and Surveys, etc...
A-75 (1921), A-1604 (1968), A-1745 (1969), B-26 (1946), B-479 (1963), B-2070 (1997), B-3460 (2010), B-3562 (2012), General Land Office 1South, Range 10 West pg. 20 (1857), Rewitness bk. 10 pg. 65 (1888), Rewitness bk. 4 pg. 84 (1950), Rewitness card #297 (1974)

History, condition, and sources:
In 1867 Samuel Snowden was contracted by the General Land Office to set quarter section corner for the line between sections 13 and 14. He set a quarter section post and 2 bearing trees. In 1889 (Rewitness bk. 10 pg. 65) A. Phillnick Deputy County Surveyor, found the quarter section post and 1 accessory set by G.L.O. In 1950 (Rewitness bk. 1 pg. 93) County Surveyor W.E. Anderson set 1 1/4" iron pipe for the quarter section corner and added 3 new accessories. In 1974 (Rewitness card #297) the Tillamook County Surveyors office found the 1 1/4" Iron pipe set for the corner and replaced it with a 2" iron pipe with 3" Tillamook County brass cap in 10" tile and concrete stamped as shown hereon. The County Surveyors office found 2 existing accessories and added 3 new accessories. In (Rewitness card #297) 1998 County Surveyor Danny McNutt added an 84" light hat section post with yellow metal location tag. In 2022 the Tillamook County Surveyors office visited the corner and found the monument to be in good condition (not legible) but no trace of any of the previous accessories were found.

- Gone: (Rewitness card #270) 12" alder S 20° W 32'
- Gone: (Rewitness card #270) rotten stump S 78° W 110.63'
- Gone: (Rewitness card #270) 27" hemlock stump N 77° E 2.7'
- Gone: (Rewitness card #270) 84" hat section post West 7.5'
- Gone: (Rewitness card #270) 72" light hat section post S 8° E 4.87'

New accessories set:

set: 84" hat section post with yellow metal location tag S 14° W 10.3'

The Monument was tied directly using G.P.S. established control. The coordinates have been converted and are provided here in WGS 84, Latitude and Longitude.

Latitude: 45° 29' 05"
Longitude: - 123° 51' 50"

Pictures of Found Monuments:

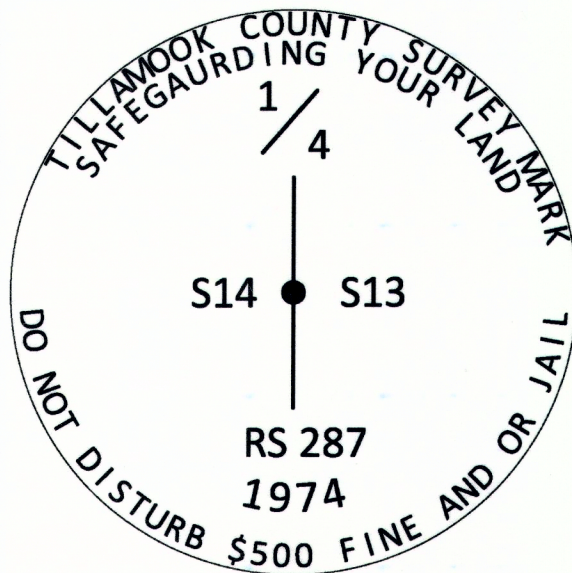

Location: Boquist Rd. to Squeedunk Rd. 3320' West, on south side of gravel road 0.4' below surface.

Tillamook County Surveyor office: 1510 3rd Street Suite C, Tillamook, OR. 97141

Party Chief: Terry Jones, P.L.S. 2507, Survey Supervisor

Witnesses: Michael Rice, P.L.S. 86926, Tillamook County Surveyor
Travis Porter, Survey Tech.

Notes: Digital images taken of monument and accessories.

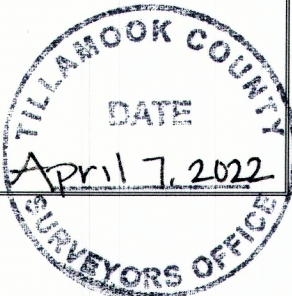

SURVEYOR'S SEAL

REGISTERED
PROFESSIONAL
LAND SURVEYOR

Terry L. Jones

OREGON
JULY 25, 1991
TERRY L. JONES
2507

RENEWAL DATE: JUNE 30, 2023